

PUTTING ON YOUR TUFF SKINZ COVER

Tuff Skinz covers all a fit pretty tight. They are custom-made for each individual brand/make of motor. It is best to use a “rocking horse” motion to install our covers. Always start at the front...

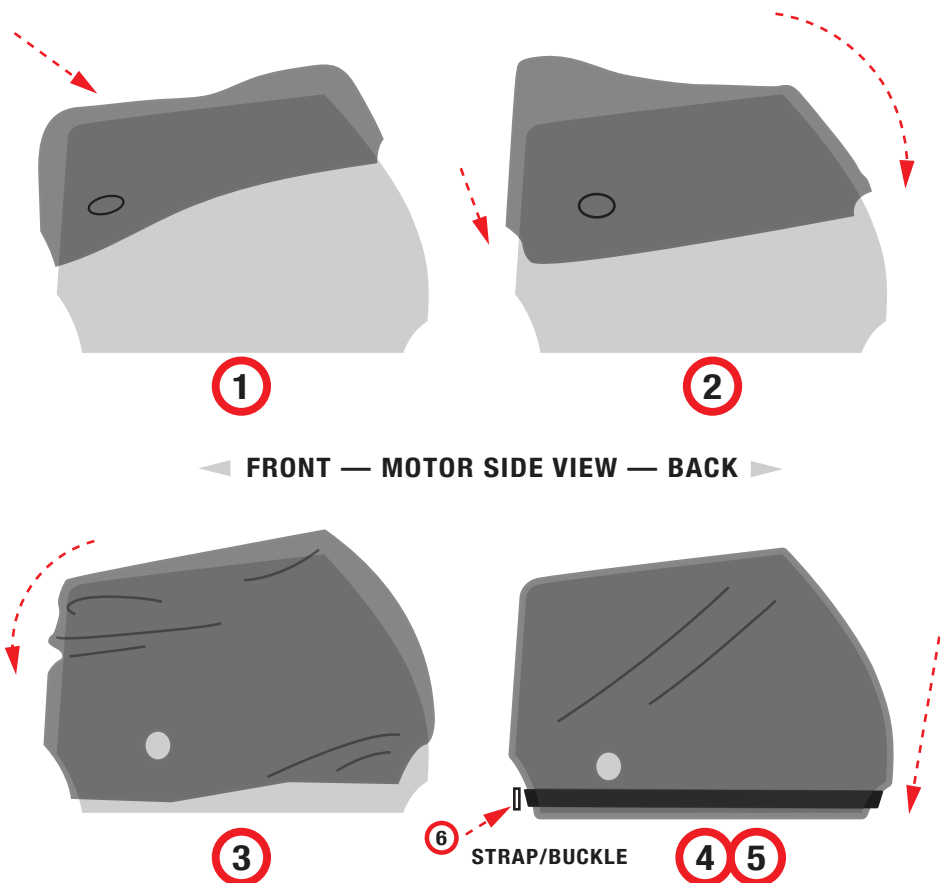

- 1.) Start by making sure buckle and strap is loose and extended out.
- 2.) Start by setting cover loosely on the front of motor.
- 3.) Then pull the back down a little more than 1/2 way (but not tight).
- 4.) Then go back to the front and pull it down all the way.
- 5.) Then go pull the back the rest of the way down (tight this time).
- 6.) Then fasten the buckle and tighten the strap.

Installation + info videos at: www.tuffskinz.net/informational-videos/